



PARTS BOOK

SECTION 1

Group No. 911-2906619Description STEERING GEAR GROUPUsed On 911BB.M. Rev.

1	2										
---	---	--	--	--	--	--	--	--	--	--	--

Page No.	Description	Group No.	Code
1	STEERING GEAR GROUP	911-2906619	2963
2	GEAR ASSEMBLY REPAIR PARTS, STEERING	911-45019	3026
3	COLUMN ASSEMBLY	911-45015	346
4			
5			
6			
7			
8			
9			
10			

Beginning Serial 911B0489 Ending Serial _____

Supercedes _____ Superceded By _____

GIVE MACHINE SERIAL NUMBER WHEN ORDERING PARTS

Issue Date 06/09/77By PF Ckd. MBAGroup No. 911-2906619

INDEX

1-2-6

Rev. 1 By PF Ckd. Evelyn

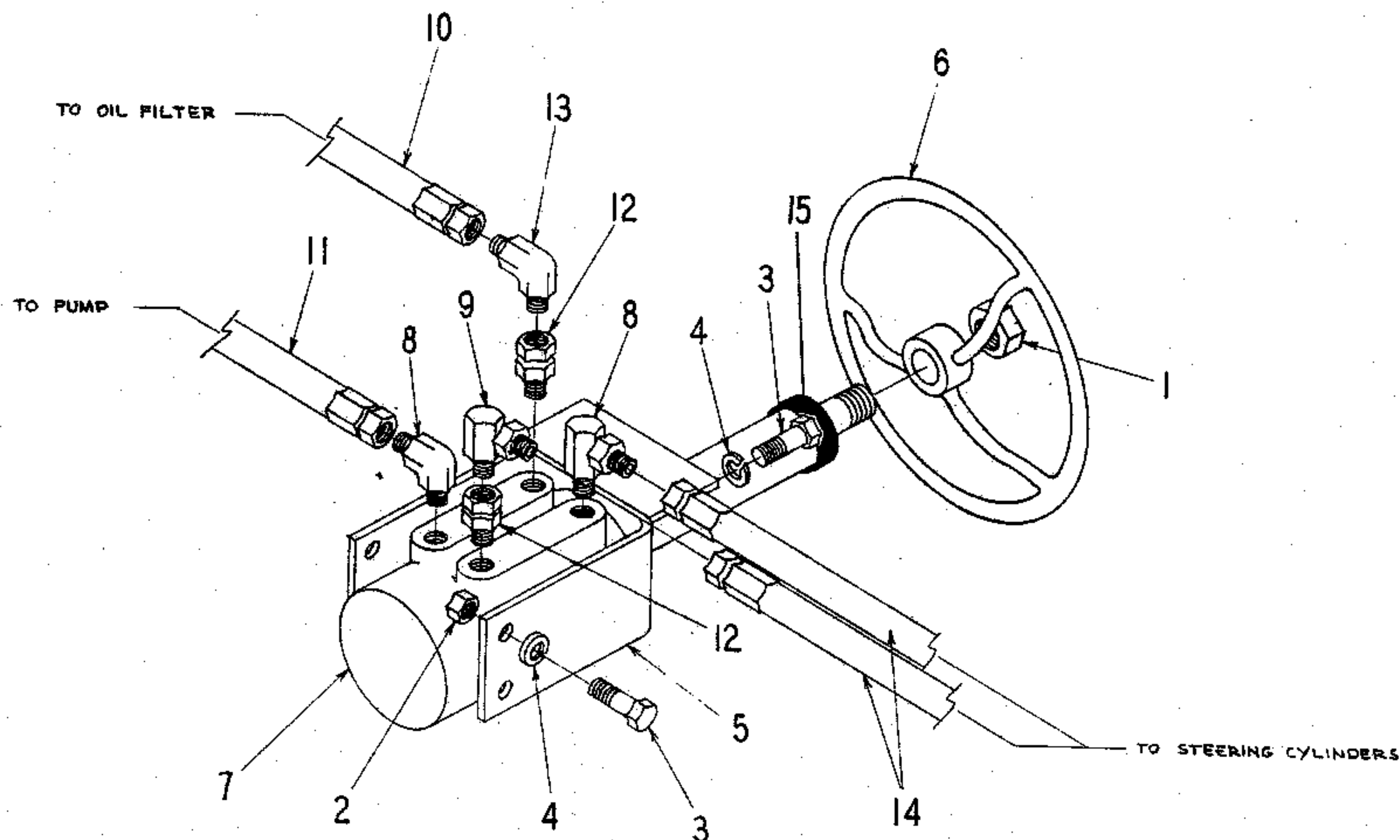

911-2906619 *

STEERING GROUP, GEAR
09/21/77

ITEM	PART NO.	QUAN.	DESCRIPTION
1	T12HJ	1	NUT, JAM
2	T6GG	4	NUT
3	T6GG20	6	SCREW, CAP
4	W6GF	6	WASHER, LOCK
5	911-45017	1	BRACKET
6	911-45018	1	WHEEL, STEERING
7	911-45019 *	1	GEAR ASSEMBLY, STEERING
8	VU8F8E20BS	2	FITTING
9	VU8F8E02BS	1	ELBOW
10	VA734	1	HOSE ASSEMBLY
11	VA968	1	HOSE ASSEMBLY
12	VW8FD8	2	FITTING
13	VU12F8E02BS	1	FITTING
14	VA834	2	HOSE ASSEMBLY
15	911-2900265	1	BOOT RUBBER

LEGEND:

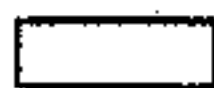

SOLD ONLY AS AN
ASSEMBLED UNIT

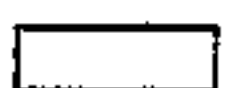

SOLD ONLY AS A KIT
OR MATCHED SET.

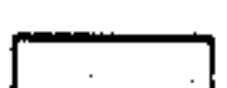

SOLD AS AN ASSEMBLED UNIT.
SERVICEABLE PARTS OF THIS ASSEMBLY ARE SHOWN
SEPARATELY UNDER THE ASSEMBLY NUMBER.



NOT SOLD AS AN ASSEMBLED UNIT.
SERVICEABLE PARTS OF THIS ASSEMBLY ARE SHOWN
SEPARATELY UNDER THE ASSEMBLY NUMBER.

GIVE MACHINE SERIAL NUMBER WHEN ORDERING PARTS

911-2906619

1-2-6

Page 1 of 3

2963

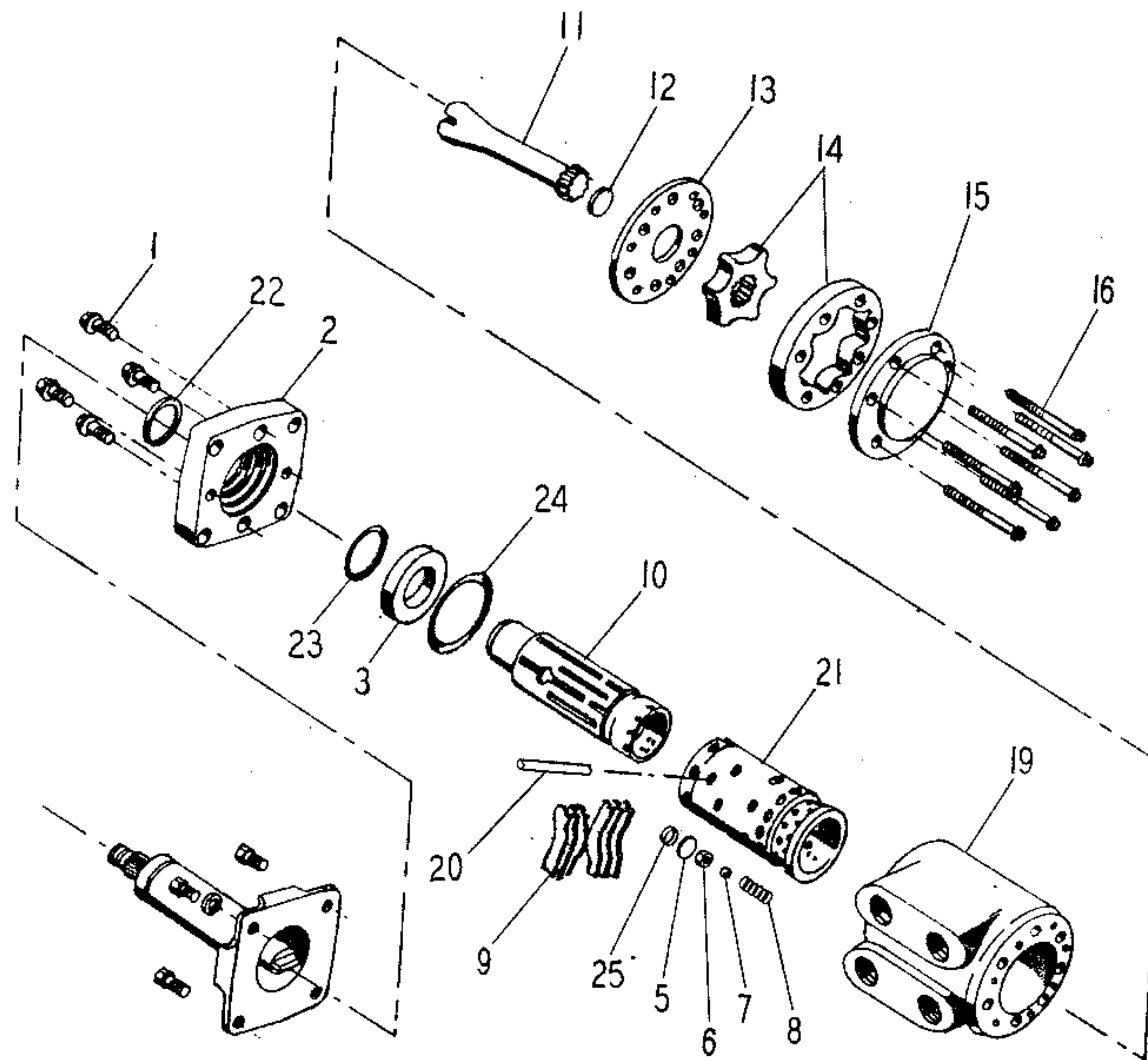

**911-45019** ★GEAR ASSEMBLY REPAIR PARTS, STEERING
00/00/00

ITEM	PART NO.	QUAN.	DESCRIPTION
1	C2L21046-1	4	SCREW, CAP
2	C2L843	1	PLATE MOUNTING
3	C2L866	1	BUSHING, CAP LOCATOR
	911-2028132 ★	1	CONTROL PARTS ASSEMBLY
5	C2L21124	1	PLUG, SEAL
6	C2L859	1	SEAT, CHECK
7	C2L18026	1	BALL, STEEL
8	C2L857	1	SPRING, COMPRESSION
9	C2L370	6	SPRING, CENTERING
10	C2L15	1	PIN, CENTERING
11	C2L5126	1	DRIVE
12	C2L20642	1	SPACER
13	C2L5414	1	PLATE
14	C2L5663-7	1	GEROTOR SET
15	C2L5415	1	CAP, END
16	C2L5389-6	7	SCREW, CAP
	911-2034601 K	1	SEAL KIT
17	T5GF14	4	SCREW, CAP
18	911-45015 ★	1	COLUMN

911-2028132 ★CONTROL PARTS ASSEMBLY
00/00/00

ITEM	PART NO.	QUAN.	DESCRIPTION
19	C2L5708-2	1	VALVE HOUSING
20	C2L5722	1	SPOOL, CONTROL
21	C2L5720	1	SLEEVE, CONTROL

911-2034601 KSEAL KIT
00/00/00

ITEM	PART NO.	QUAN.	DESCRIPTION
22	N.S.S.	1	SEAL, OIL
23	N.S.S.	1	SEAL, QUAD RING
24	N.S.S.	1	SEAL, O-RING
25	N.S.S.	1	SEAL, O-RING

N.S.S. NOT SOLD SEPERATELY

LEGEND:

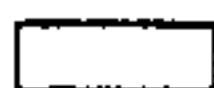
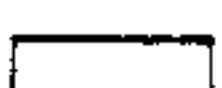
SOLD ONLY AS AN
ASSEMBLED UNITSOLD ONLY AS A KIT
OR MATCHED SETSOLD AS AN ASSEMBLED UNIT.
SERVICEABLE PARTS OF THIS ASSEMBLY ARE SHOWN
SEPARATELY UNDER THE ASSEMBLY NUMBER.NOT SOLD AS AN ASSEMBLED UNIT.
SERVICEABLE PARTS OF THIS ASSEMBLY ARE SHOWN
SEPARATELY UNDER THE ASSEMBLY NUMBER.**GIVE MACHINE SERIAL NUMBER WHEN ORDERING PARTS**

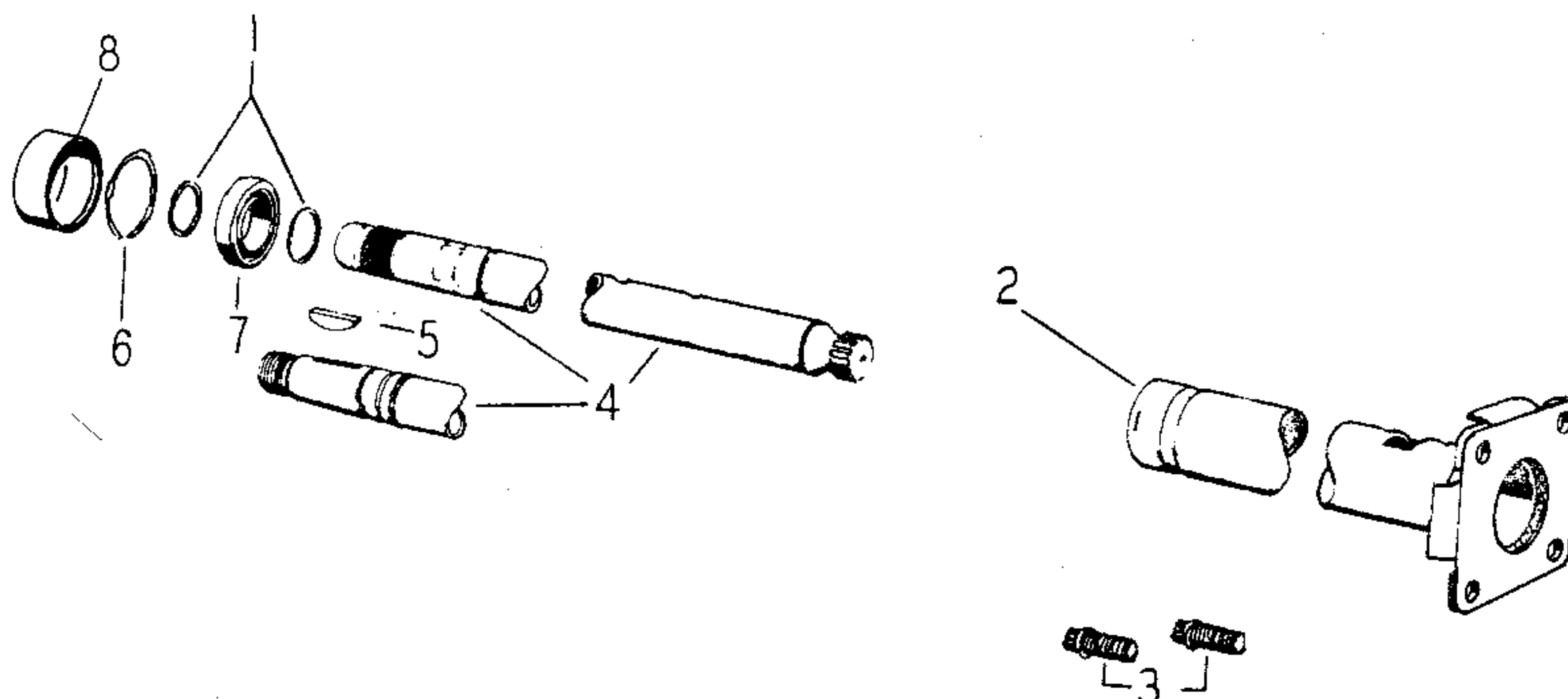

911-45015 ★
COLUMN ASSEMBLY
00/00/00

ITEM	PART NO.	QUAN.	DESCRIPTION
1	C2L14092	2	SNAP RING
2	C2L5246-2	1	TUBE AND FLANGE ASSEMBLY
3	T6HG12	2	CAP SCREW
4	C2L5260-1	1	SHAFT ASSEMBLY
5	C2L655	1	KEY
6	C2L5245	1	RETAINING RING
7	C2L21146	1	BEARING
8	C2L20836	1	BOOT, RUBBER

LEGEND:

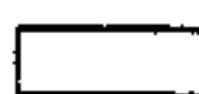
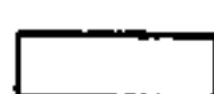
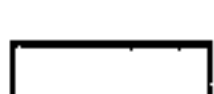
SOLD ONLY AS AN
ASSEMBLED UNITSOLD ONLY AS A KIT
OR MATCHED SET.SOLD AS AN ASSEMBLED UNIT.
SERVICEABLE PARTS OF THIS ASSEMBLY ARE SHOWN
SEPARATELY UNDER THE ASSEMBLY NUMBER.NOT SOLD AS AN ASSEMBLED UNIT.
SERVICEABLE PARTS OF THIS ASSEMBLY ARE SHOWN
SEPARATELY UNDER THE ASSEMBLY NUMBER.

GIVE MACHINE SERIAL NUMBER WHEN ORDERING PARTS